

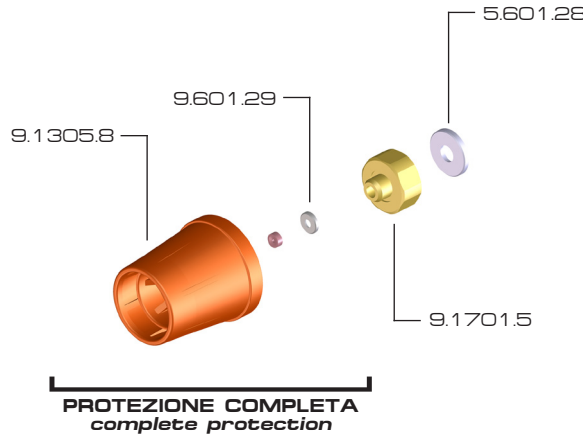

FLUID
SPRAYING
AND
ENGINEERING

PROTEZIONE "TURBO" "TURBO" PROTECTION



◀ PAGE 25/47 ▶

FORO mm	PRESTAZIONI	PRESSIONE					
		15 bar		30 bar		50 bar	
		cono	spillo	cono	spillo	cono	spillo
Ø1.0	portata l/min angolo di spruzzo gittata max. m.	1.8 30° 2.1	2.3 - 5.0	2.6 35° 2.4	3.2 - 5.6	3.4 40° 2.8	4.1 - 6.3
Ø1.2	portata l/min angolo di spruzzo gittata max. m.	2.4 35° 2.3	3.0 - 5.8	3.4 40° 2.7	4.2 - 6.1	4.4 45° 3.1	5.4 - 6.8
Ø1.5	portata l/min angolo di spruzzo gittata max. m.	3.4 40° 2.6	4.5 - 6.6	4.8 45° 3.0	6.4 - 7.0	6.2 50° 3.5	8.3 - 7.7
Ø1.8	portata l/min angolo di spruzzo gittata max. m.	3.9 50° 2.9	6.9 - 7.0	5.5 55° 3.3	9.8 - 7.5	7.1 60° 4.0	12.7 - 8.3
Ø2.0	portata l/min angolo di spruzzo gittata max. m.	4.5 55° 3.1	8.3 - 7.5	6.3 60° 3.5	11.7 - 8.0	8.1 65° 4.5	15.1 - 8.9
Ø2.3	portata l/min angolo di spruzzo gittata max. m.	5.3 60° 3.4	11.4 - 8.0	7.5 65° 4.0	16.1 - 8.5	9.7 75° 4.8	20.8 - 9.3

HOLE mm	PERFORMANCES	PRESSURE					
		200 psi		450 psi		700 psi	
		cone	straight	cone	straight	cone	straight
Ø1.0	capacity US/GPM spray angle max. throw ft.	0.44 30° 6.3	0.56 - 15.1	0.71 35° 8.1	0.87 - 19.0	0.87 40° 8.9	1.05 - 20.0
Ø1.2	capacity US/GPM spray angle max. throw ft.	0.58 35° 6.9	0.73 - 17.5	0.93 40° 9.2	1.15 - 20.7	1.12 45° 9.8	1.38 - 21.5
Ø1.5	capacity US/GPM spray angle max. throw ft.	0.83 40° 7.8	1.10 - 20.0	1.31 45° 10.2	1.78 - 23.8	1.59 50° 11.1	2.12 - 24.4
Ø1.8	capacity US/GPM spray angle max. throw ft.	0.95 50° 8.7	1.68 - 21.2	1.50 55° 11.2	2.68 - 25.5	1.81 60° 12.6	3.24 - 26.3
Ø2.0	capacity US/GPM spray angle max. throw ft.	1.10 55° 9.4	2.02 - 22.6	1.72 60° 11.9	3.20 - 27.2	2.07 65° 14.3	3.85 - 28.2
Ø2.3	capacity US/GPM spray angle max. throw ft.	1.29 60° 10.3	2.77 - 24.1	2.05 65° 13.6	4.40 - 28.9	2.47 75° 15.3	5.31 - 29.5

COME SI ORDINA / HOW TO ORDER

PROTEZIONE COMPLETA complete protection	Ø mm	SOLO PROTEZIONE protection only	SOLO UGELLO spray tip only	Ø mm	SOLO GUARNIZIONI gaskets only	SOLO TESTA cap only	
9.1312.2	10	9.1305.8	9.801.12	1.0	9.601.29 5.601.28	9.1701.5	10
9.1312.3	12		9.801.13	1.2			
9.1312.1	15		9.801.14	1.5			
9.1312.4	18		9.801.15	1.8			
9.1312.5	20		9.801.16	2.0			
9.1312.6	23		9.801.17	2.3			

